

BILL OF MATERIALS

ITEM	QTY	PART NO.	DESCRIPTION
1	1	130-01560P	U1560P DETAILER WELDMENT, TUBE & AC50A, INCLUDES #2
2	1	826-00600	Ø1½" 304 SS TUBE x 6" LENGTH
3	1	TJP8002	SS TIP, PLASTIC TEE JET
4	1	010-E	#010 EPDM O-RING
5	2	72395	#8-32 x 5/16" SS PHILLIPS HEAD MACHINE SCREW
6	1	811-06600	18GA RETAINER PLATE
7	1	210-12600	MANIFOLD ASSEMBLY
8	1	CFT6	1/8" MPT x 3/16" TUBE FERRULE
9	2	102-1-VHG	AC31V5, Ø1½" ALUMINUM VALVE HANGER
10	1	73441	#10-24 x 1/4" SS SHCS
11	1	70857	#10-24 SS NYLOC NUT
12	1	V1245P	120PSI PLASTIC VALVE ASSEMBLY
13	1	WHP1231-06	AC38, 1/8" MPT x 1/4" MPT, 6" LENGTH

REVISIONS		
REV	DESCRIPTION	DATE
A	DELETED WORM DRIVE CLAMPS ~ MODIFIED ITEM 12	10/17/97
B	REVISED ITEMS 2,7,& 8	10/17/97
C	REVISED #1 FROM U1560P TO U1260P & #7 FROM H53P-8002 TO DP8002	7/20/09
D	UPDATED PART NUMBERS	3/24/2010
E	#8-32 x 5/16" SCREW WAS P/N 70785 TUBE WAS INCORRECTLY SHOWN AS Ø1-1/4"	11-17-2010

NOTES:

1. PACKAGE PART IN 8" x 15" POLYBAG

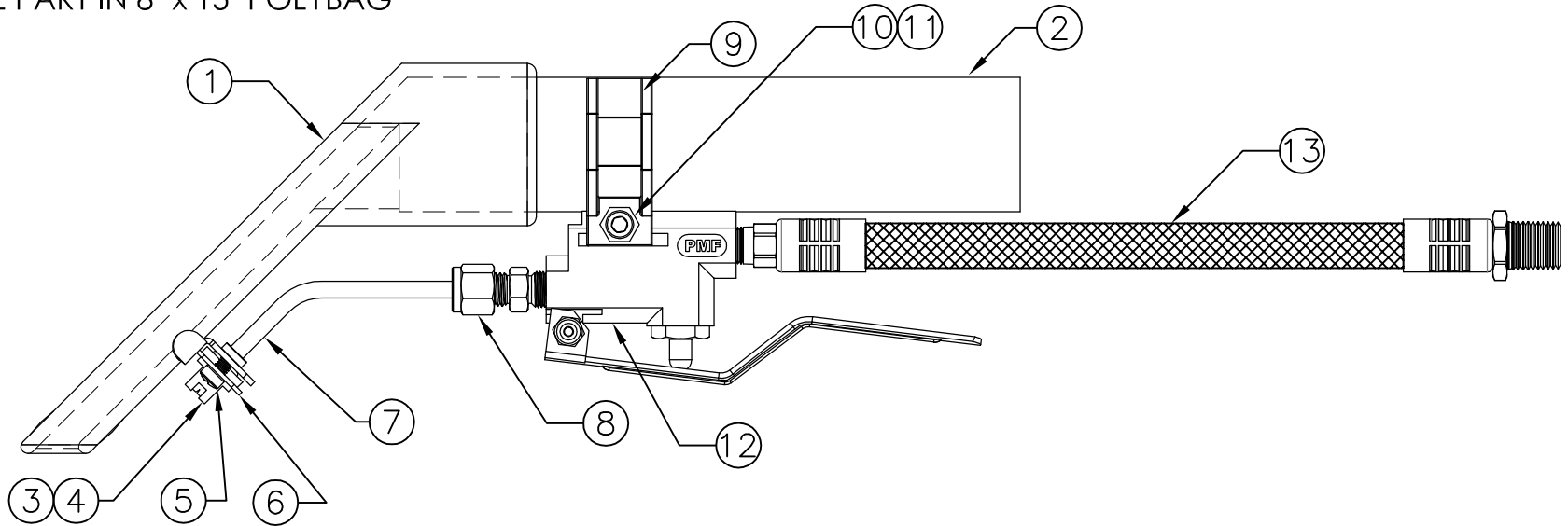

DEPARTMENTS:

✓ Tool Department

TOLERANCES .X = .050" .XX = .010" .XXX = .005"		NAME PLASTIC HEAD EXT. SPRAY DETAILER, 120PSI		
ANGLES .X = .5°		CUSTOMER PMF		
DWG NO. PMF01-50031ASM	SIZE A	DATE: 11-17-2010	PART NO. U1560P	REV E
ALL DIMENSIONS IN INCHES UNLESS OTHERWISE NOTED	SCALE 1:2	DRAWN M. TERRELL	SHEET 1 OF 1	
IMF PRODUCTION METAL FORMING 8888 Highway 66 Klamath Falls, OR 97601		The information contained in this document is the property of Production Metal Forming Inc. and shall not be reproduced or disclosed to other persons or companies except as specifically authorized in writing by Production Metal Forming.		